



A Complete System in Circuit Protection



RESIDUAL CURRENT OPERATED CIRCUIT BREAKERS WITH INTEGRAL OVERCURRENT PROTECTION (RCBO)

PRODUCT FEATURES

- Combination of Overload, Short Circuit & Earth Leakage Protection in one single unit device.
- Modular & Compact design equivalent to one module space for easy installation & maintenance.
- Tested in Compliance to IEC 61009-1 : 2010 / IEC 61009-2-2 : 1991
- Suitable for Residential & Commercial applications.



A Complete System in Circuit Protection

RESIDUAL CURRENT OPERATED CIRCUIT BREAKERS WITH INTEGRAL OVERCURRENT PROTECTION (RCBO)

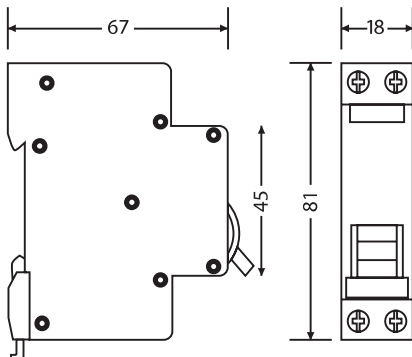

TECHNICAL DATA & SPECIFICATIONS	
Type of RCBO	Type AC & A
Design Standard	IEC 61009-1 : 2010 / IEC 61009-2-2 : 1991
Rated Current (In)	6, 10, 16, 20, 25 & 32A
Rated Residual Current (I Δ n)	10mA & 30mA
Rated Voltage (Un)	240V
Rated Short Circuit Capacity	6kA
Rated Frequency (Hz)	50/60Hz
Instantaneous Tripping Curve	B, C (IEC 60898-1)
Operation Endurance	>4,000 cycles
Degree of Protection	IP20
Energy Limiting Class	3
Terminal Capacity	up to 10mm
Mounting Capacity	Din Rail 50022

MODEL NO. HNA3LE32

PRODUCT CODE		RATED	RESIDUAL	BREAKING	MAGNETIC
TYPE AC	TYPE A	CURRENT	CURRENT	CAPACITY	TRIPPING
CAT NO.	CAT NO.	(AMP)	(MA)	(1CN)	CHARACTERISTIC
610AC	610A	6	10	6KA	C CURVE
1010AC	1010A	10	10		
1610AC	1610A	16	10		
2010AC	2010A	20	10		
2510AC	2510A	25	10		
3210AC	3210A	32	10		



UTAMA SWITCHGEAR SDN BHD (418650-H)
No. 3, Jalan USJ 19/4A, UEP Subang Jaya,
47630 Petaling Jaya, Selangor Darul Ehsan, Malaysia.
Tel 603-8024 1215 / 1216 Fax 603-8024 1796
Email utamasb@unifi.my

Dealer: